

	Slanted with lip	Slanted	Square	Square with lip	Rounded
105mm					
95mm					
85mm					
75mm					

Part number	Description	Paint finish	Length in m ¹ Pack. Unit
-------------	-------------	--------------	--

SolidScreen 75

For the SolidScreen 75, apply the end fix brackets below, top cover and bottom cover, in combination with alu roller 51:

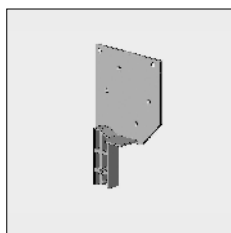

4452 365-000	End fix bracket Excellent 75 slanted without spindle, left	Mill finish	
4452 366-000	Idem, right	Mill finish	
4452 365-008	End fix bracket Excellent 75 slanted without spindle, left	RAL 7035 light grey	
4452 366-008	Idem, right	RAL 7035 light grey	
4452 365-006	End fix bracket Excellent 75 slanted without spindle, left	RAL 9010 pure white	
4452 366-006	Idem, right	RAL 9010 pure white	
4452 365-901	End fix bracket Excellent 75 slanted without spindle, left	RAL 9001 cream	
4452 366-901	Idem, right	RAL 9001 cream	
4452 365-716	End fix bracket Excellent 75 slanted without spindle, left	RAL 7016 anthracite grey	
4452 366-716	Idem, right	RAL 7016 anthracite grey	

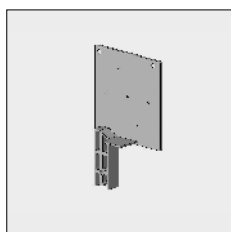

4452 404-000	End fix bracket Excellent 75 square without spindle, left	Mill finish	
4452 406-000	Idem, right	Mill finish	

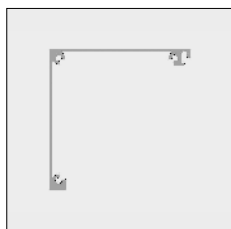

6296 691-000	Alu top cover Excellent 75	Mill finish	7.0
6296 692-000	Idem	Mill finish	7.5
6296 691-016	Alu top cover Excellent 75	Silver anodized	7.0
6296 691-006	Alu top cover Excellent 75	RAL 9010 pure white	7.0
6296 692-006	Idem	RAL 9010 pure white	7.5
6296 691-901	Alu top cover Excellent 75	RAL 9001 cream	7.0
6296 692-901	Idem	RAL 9001 cream	7.5
6296 691-716	Alu top cover Excellent 75	RAL 7016 anthracite grey	7.0

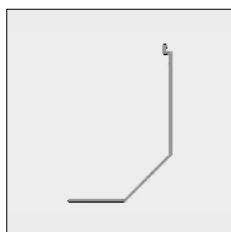

6296 742-000	Alu bottom cover slanted Excellent 75	Mill finish	7.0
6296 744-000	Idem	Mill finish	7.5
6296 742-016	Alu bottom cover slanted Excellent 75	Silver anodized	7.0
6296 742-006	Alu bottom cover slanted Excellent 75	RAL 9010 pure white	7.0
6296 744-006	Idem	RAL 9010 pure white	7.5
6296 742-901	Alu bottom cover slanted Excellent 75	RAL 9001 cream	7.0
6296 744-901	Idem	RAL 9001 cream	7.5

= Article will be sold out. Special orders remain possible.

SolidScreen® XS

Part number	Description	Paint finish	Length in m ¹ Pack. Unit
6296 695-000	Alu bottom cover slanted with lip Excellent 75	Mill finish	7.0
6296 697-016	Idem	Silver anodized	7.0
6296 695-006	Idem	RAL 9010 pure white	7.0
6296 697-901	Idem	RAL 9001 cream	7.0
6296 695-716	Idem	RAL 7016 anthracite grey	7.0

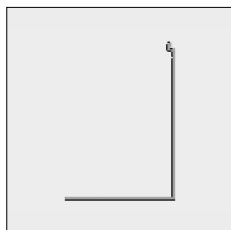
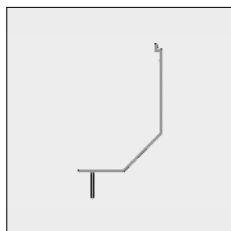

6296 873-000	Alu bottom cover square Excellent 75	Mill finish	7.5
--------------	--------------------------------------	-------------	-----

SolidScreen 85

For the SolidScreen 85, apply the end fix brackets below, top cover and bottom cover, in combination with alu roller 51:

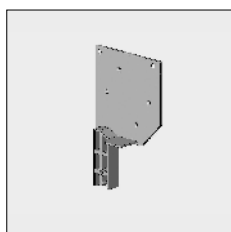

4452 185-000	End fix bracket Excellent 85, left	Mill finish
4452 186-000	Idem, right	Mill finish
4452 185-008	End fix bracket Excellent 85, left	RAL 7035 light grey
4452 186-008	Idem, right	RAL 7035 light grey
4452 185-006	End fix bracket Excellent 85, left	RAL 9010 pure white
4452 186-006	Idem, right	RAL 9010 pure white
4452 185-901	End fix bracket Excellent 85, left	RAL 9001 cream
4452 186-901	Idem, right	RAL 9001 cream
4452 185-716	End fix bracket Excellent 85, left	RAL 7016 anthracite grey
4452 186-716	Idem, right	RAL 7016 anthracite grey

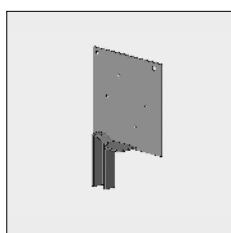

4453 114-000	Alu end fix bracket Excellent 85 square without spindle, left	Mill finish
4453 116-000	Idem, right	Mill finish
4452 414-008	End fix bracket Excellent 85 square without spindle, left	RAL 7035 light grey
4452 416-008	Idem, right	RAL 7035 light grey
4452 414-006	End fix bracket Excellent 85 square without spindle, left	RAL 9010 pure white
4452 416-006	Idem, right	RAL 9010 pure white

= Article will be sold out. Special orders remain possible.

Part number	Description	Paint finish	Length in m ¹ Pack. Unit
6296 756-000	Alu top cover Excellent 85	Mill finish	7.0
6296 758-000	Idem	Mill finish	7.5
6296 756-016	Alu top cover Excellent 85	Silver anodized	7.0
6296 758-016	Idem	Silver anodized	7.5
6296 756-006	Alu top cover Excellent 85	RAL 9010 pure white	7.0
6296 758-006	Idem	RAL 9010 pure white	7.5
6296 756-901	Alu top cover Excellent 85	RAL 9001 cream	7.0
6296 758-901	Idem	RAL 9001 cream	7.5
6296 756-716	Alu top cover Excellent 85	RAL 7016 anthracite grey	7.0
6296 748-000	Alu bottom cover slanted Excellent 85	Mill finish	7.0
6296 749-000	Idem	Mill finish	7.5
6296 748-016	Alu bottom cover slanted Excellent 85	Silver anodized	7.0
6296 749-016	Idem	Silver anodized	7.5
6296 748-006	Alu bottom cover slanted Excellent 85	RAL 9010 pure white	7.0
6296 749-006	Idem	RAL 9010 pure white	7.5
6296 748-901	Alu bottom cover slanted Excellent 85	RAL 9001 cream	7.0
6296 749-901	Idem	RAL 9001 cream	7.5
6296 748-716	Alu bottom cover slanted Excellent 85	RAL 7016 anthracite grey	7.0
6296 645-000	Alu bottom cover slanted with lip Excellent 85	Mill finish	7.0
6296 645-016	Idem	Silver anodized	7.0
6296 645-006	Idem	RAL 9010 pure white	7.0
6296 645-901	Idem	RAL 9001 cream	7.0
6296 645-716	Idem	RAL 7016 anthracite grey	7.0
6296 875-000	Alu bottom cover square Excellent 85	Mill finish	7.0
6296 878-000	Idem	Mill finish	7.5
6296 875-016	Alu bottom cover square Excellent 85	Silver anodized	7.0
6296 878-016	Idem	Silver anodized	7.5
6296 875-006	Alu bottom cover square Excellent 85	RAL 9010 pure white	7.0
6296 878-006	Idem	RAL 9010 pure white	7.5

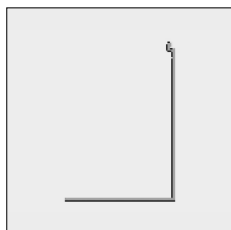
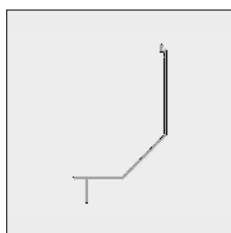
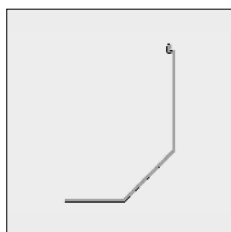
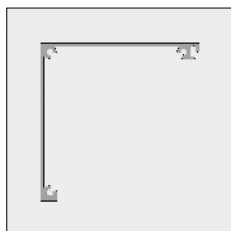

= Article will be sold out. Special orders remain possible.

SolidScreen® XS

Part number	Description	Paint finish	Length in m ¹ Pack. Unit
-------------	-------------	--------------	--

SolidScreen 95

For the SolidScreen 95, apply the end fix brackets below, top cover and bottom cover, in combination with steel roller 63:

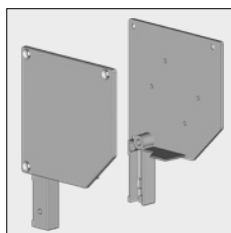

4453 000-000	Alu end fix bracket Excellent 95 slanted without spindle and tab, left	Mill finish	
4453 002-000	Idem, right	Mill finish	
4453 000-008	Alu end fix bracket Excellent 95 slanted without spindle and tab, left	RAL 7035 grey	
4453 002-008	Idem, right	RAL 7035 grey	
4453 000-006	Alu end fix bracket Excellent 95 slanted without spindle and tab, left	RAL 9010 pure white	
4453 002-006	Idem, right	RAL 9010 pure white	
4453 000-901	Alu end fix bracket Excellent 95 slanted without spindle and tab, left	RAL 9001 cream	
4453 002-901	Idem, right	RAL 9001 cream	
4453 000-716	Alu end fix bracket Excellent 95 slanted without spindle and tab, left	RAL 7016 anthracite grey	
4453 002-716	Idem, right	RAL 7016 anthracite grey	
4453 000-755	Alu end fix bracket Excellent 95 slanted without spindle and tab, left (* = textured)	RAL 7016 anthracite grey*	
4453 002-755	Idem, right (* = textured)	RAL 7016 anthracite grey*	

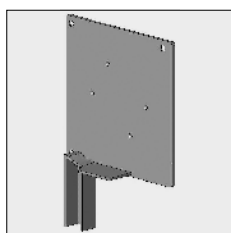

4453 124-000	Alu end fix bracket Excellent 95 square without spindle, left	Mill finish	
4453 126-000	Idem, right	Mill finish	
4453 124-008	Alu end fix bracket Excellent 95 square without spindle, left	RAL 7035 grey	
4453 126-008	Idem, right	RAL 7035 grey	

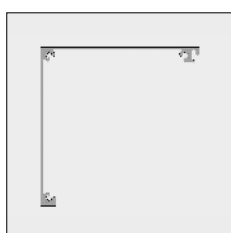

6296 770-000	Alu top cover Excellent 95	Mill finish	7.0
6296 772-000	Idem	Mill finish	7.5
6296 770-016	Alu top cover Excellent 95	Silver anodized	7.0
6296 772-016	Idem	Silver anodized	7.5
6296 770-006	Alu top cover Excellent 95	RAL 9010 pure white	7.0
6296 772-006	Idem	RAL 9010 pure white	7.5
6296 770-901	Alu top cover Excellent 95	RAL 9001 cream	7.0
6296 772-901	Idem	RAL 9001 cream	7.5
6296 770-716	Alu top cover Excellent 95	RAL 7016 anthracite grey	7.0
6296 770-755	Alu top cover Excellent 95 (* = textured)	RAL 7016 anthracite grey*	7.0

= Article will be sold out. Special orders remain possible.

Part number	Description	Paint finish	Length in m ¹ Pack. Unit
-------------	-------------	--------------	--



4452 083-000	Plate screw with countersunk Philips head 3.5 x 16 mm (For fixing the top cover to the end fix bracket)		100
--------------	--	--	-----

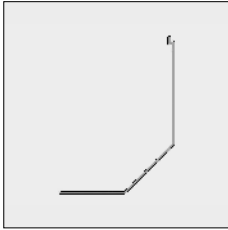

6296 890-000	Alu bottom cover 95 slanted	Mill finish	7.0
--------------	-----------------------------	-------------	-----

6296 891-000	Idem	Mill finish	7.5
--------------	------	-------------	-----

6296 764-016	Alu bottom cover 95 slanted	Silver anodized	7.0
--------------	-----------------------------	-----------------	-----

6296 891-016	Idem	Silver anodized	7.5
--------------	------	-----------------	-----

6296 890-006	Alu bottom cover 95 slanted	RAL 9010 pure white	7.0
--------------	-----------------------------	---------------------	-----

6296 891-006	Idem	RAL 9010 pure white	7.5
--------------	------	---------------------	-----

6296 764-901	Alu bottom cover 95 slanted	RAL 9001 cream	7.0
--------------	-----------------------------	----------------	-----

6296 891-901	Idem	RAL 9001 cream	7.5
--------------	------	----------------	-----

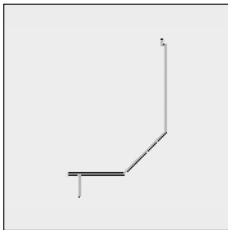

6297 360-000	Alu bottom cover 95 slanted with lip	Mill finish	7.0
--------------	--------------------------------------	-------------	-----

6297 360-016	Idem	Silver anodized	7.0
--------------	------	-----------------	-----

6297 360-006	Idem	RAL 9010 pure white	7.0
--------------	------	---------------------	-----

6297 360-901	Idem	RAL 9001 cream	7.0
--------------	------	----------------	-----

6297 360-716	Idem	RAL 7016 anthracite grey	7.0
--------------	------	--------------------------	-----

6297 360-755	Idem (* = textured)	RAL 7016 anthracite grey*	7.0
--------------	---------------------	---------------------------	-----

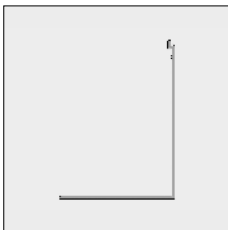

6297 382-000	Alu bottom cover 95 square	Mill finish	7.5
--------------	----------------------------	-------------	-----

6297 382-016	Idem	Silver anodized	7.5
--------------	------	-----------------	-----

SolidScreen 105

For the SolidScreen 105, apply the end fix brackets below, top cover and bottom cover, in combination with steel roller 78:

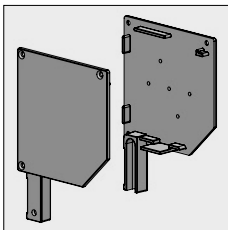

4452 450-000	Alu end fix bracket 105 slanted without spindle, left	Mill finish	
--------------	---	-------------	--

4452 452-000	Idem, right	Mill finish	
--------------	-------------	-------------	--

4452 450-008	Alu end fix bracket 105 slanted without spindle, left	RAL 7035 grey	
--------------	---	---------------	--

4452 452-008	Idem, right	RAL 7035 grey	
--------------	-------------	---------------	--

4452 450-006	Alu end fix bracket 105 slanted without spindle, left	RAL 9010 pure white	
--------------	---	---------------------	--

4452 452-006	Idem, right	RAL 9010 pure white	
--------------	-------------	---------------------	--

4452 450-901	Alu end fix bracket 105 slanted without spindle, left	RAL 9001 cream	
--------------	---	----------------	--

4452 452-901	Idem, right	RAL 9001 cream	
--------------	-------------	----------------	--

4452 450-716	Alu end fix bracket 105 slanted without spindle, left	RAL 7016 anthracite grey	
--------------	---	--------------------------	--

4452 452-716	Idem, right	RAL 7016 anthracite grey	
--------------	-------------	--------------------------	--

4452 450-755	Alu end fix bracket 105 slanted without spindle, left (* = textured)	RAL 7016 anthracite grey*	
--------------	---	---------------------------	--

4452 452-755	Idem, right (* = textured)	RAL 7016 anthracite grey*	
--------------	----------------------------	---------------------------	--

= Article will be sold out. Special orders remain possible.

SolidScreen® XS

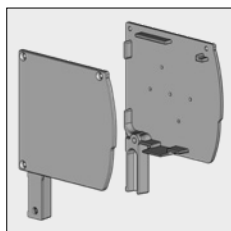

Part number	Description	Paint finish	Length in m ¹ Pack. Unit
4453 014-000	Alu end fix bracket 105 rounded without spindle, left	Mill finish	
4453 016-000	Idem, right	Mill finish	
4453 014-008	Alu end fix bracket 105 rounded without spindle, left	RAL 7035 grey	
4453 016-008	Idem, right	RAL 7035 grey	
4453 014-006	Alu end fix bracket 105 rounded without spindle, left	RAL 9010 pure white	
4453 016-006	Idem, right	RAL 9010 pure white	
4453 014-901	Alu end fix bracket 105 rounded without spindle, left	RAL 9001 cream	
4453 016-901	Idem, right	RAL 9001 cream	
4453 014-716	Alu end fix bracket 105 rounded without spindle, left	RAL 7016 anthracite grey	
4453 016-716	Idem, right	RAL 7016 anthracite grey	
4453 014-755	Alu end fix bracket 105 rounded without spindle, left (* = textured)	RAL 7016 anthracite grey*	
4453 016-755	Idem, right (* = textured)	RAL 7016 anthracite grey*	

6

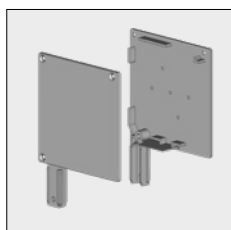

4452 580-000	Alu end fix bracket 105 square without spindle, left	Mill finish	
4452 582-000	Idem, right	Mill finish	
4452 580-008	Alu end fix bracket 105 square without spindle, left	RAL 7035 grey	
4452 582-008	Idem, right	RAL 7035 grey	
4452 580-006	Alu end fix bracket 105 square without spindle, left	RAL 9010 pure white	
4452 582-006	Idem, right	RAL 9010 pure white	
4452 580-901	Alu end fix bracket 105 square without spindle, left	RAL 9001 cream	
4452 582-901	Idem, right	RAL 9001 cream	
4452 580-716	Alu end fix bracket 105 square without spindle, left	RAL 7016 anthracite grey	
4452 582-716	Idem, right	RAL 7016 anthracite grey	
4452 580-755	Alu end fix bracket 105 square without spindle, left (* = textured)	RAL 7016 anthracite grey*	
4452 582-755	Idem, right (* = textured)	RAL 7016 anthracite grey*	

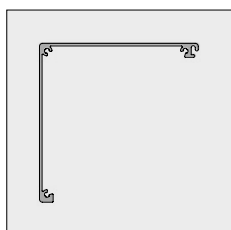

6297 653-000	Alu top cover 105	Mill finish	4.1
6297 653-006	Idem	RAL 9010 pure white	4.1
6297 653-755	Idem (* = textured)	RAL 7016 anthracite grey*	4.1

= Article will be sold out. Special orders remain possible.

Part number	Description	Paint finish	Length in m ¹ Pack. Unit
6297 658-000	Alu top cover 105	Mill finish	7.0
6297 658-016	Idem	Silver anodized	7.0
6297 658-006	Idem	RAL 9010 pure white	7.0
6297 658-901	Idem	RAL 9001 cream	7.0
6297 658-716	Idem	RAL 7016 anthracite grey	7.0
6297 658-755	Idem (* = textured)	RAL 7016 anthracite grey*	7.0

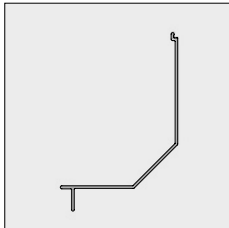

6297 673-000	Alu bottom cover slanted with lip 105	Mill finish	4.1
6297 673-006	Idem	RAL 9010 pure white	4.1
6297 673-755	Idem (* = textured)	RAL 7016 anthracite grey*	4.1

6297 678-000	Alu bottom cover slanted with lip 105	Mill finish	7.0
6297 678-016	Idem	Silver anodized	7.0
6297 678-006	Idem	RAL 9010 pure white	7.0
6297 678-901	Idem	RAL 9001 cream	7.0
6297 678-716	Idem	RAL 7016 anthracite grey	7.0
6297 678-755	Idem (* = textured)	RAL 7016 anthracite grey*	7.0

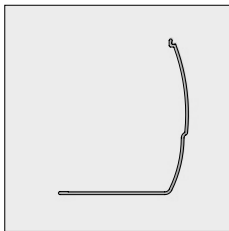

6297 685-000	Alu bottom cover rounded 105	Mill finish	7.0
6297 685-016	Idem	Silver anodized	7.0
6297 685-006	Idem	RAL 9010 pure white	7.0
6297 685-901	Idem	RAL 9010 pure white	7.0
6297 685-716	Idem	RAL 7016 anthracite grey	7.0
6297 685-755	Idem (* = textured)	RAL 7016 anthracite grey*	7.0

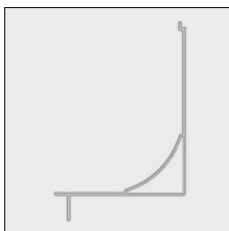

6297 801-000	Alu bottom cover square with lip 105	Mill finish	4.1
6297 801-006	Idem	RAL 9010 pure white	4.1
6297 801-755	Idem (* = textured)	RAL 7016 anthracite grey*	4.1

6297 807-000	Alu bottom cover square with lip 105	Mill finish	7.0
6297 807-016	Idem	Silver anodized	7.0
6297 807-006	Idem	RAL 9010 pure white	7.0
6297 807-901	Idem	RAL 9010 pure white	7.0
6297 807-716	Idem	RAL 7016 anthracite grey	7.0
6297 807-755	Idem (* = textured)	RAL 7016 anthracite grey*	7.0

The parts mentioned below are for SolidScreen XS 95 and 105:



4452 084-000	Stainless steel plate screw with Philips cylinder head 3.5 x 6.5 mm (For fixing the bottom cover to the end fix bracket)	100
--------------	---	-----



4452 097-000	Stainless steel (AISI410) drill screw ZB,BK/KK 3.5 x 9.5 mm (For fixing the bottom cover to the end fix bracket, no drilling required)	100
--------------	---	-----

= Article will be sold out. Special orders remain possible.

SolidScreen® XS

Part number	Description	Paint finish	Length in m ¹ Pack. Unit
-------------	-------------	--------------	--

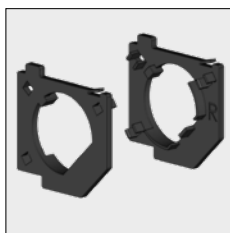

4453 390-905	Fixing plate for ASA motors, left	Black	10
4453 392-905	Idem, right	Black	10

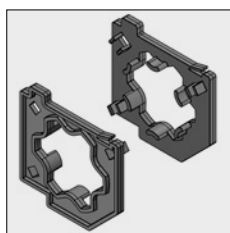

4452 693-905	Fixing plate for Somfy motors, left	Black	10
4452 694-905	Idem, right	Black	10

Use the nylon fixing plates below in combination with the end fix brackets 95 or 105 WITHOUT spindle and bearing pin. DO NOT apply the fixing plates for the motor.

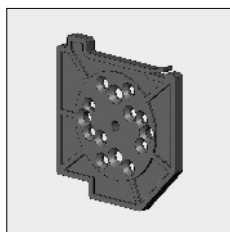

4452 695-080	Nylon fixing plate without spindle, left	Grey	25
4452 697-080	Idem, right	Black	25

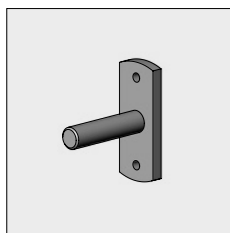

4210 498-080	Bearing pin 12 mm with fixing plate	Zinc-plated	10
--------------	-------------------------------------	-------------	----

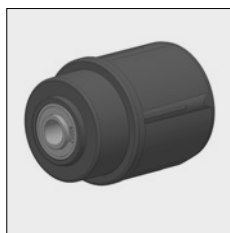

4453 051-068	Nylon bearing roller bung SolidScreen XS for tube 63 incl. precision bearings with high inner ring.	Black	
--------------	---	-------	--



4453 055-905	Nylon motor roller bung Solidscreen XS for tube 63. For ASA motor series 50 or Somfy motor series 50.	Black	10
--------------	---	-------	----

= Article will be sold out. Special orders remain possible.

Part number	Description	Paint finish	Length in m ¹ Pack. Unit
	4453 590-068 Kit bearing + Adaption roller bung SolidScreen XS for tube 78 incl. precision bearings with high inner ring.	Black	10
	4452 549-068 Alu centre bracket SolidScreen 95		
	4452 560-068 Alu centre bracket SolidScreen 105		
	4453 250-068 Alu couple bearing tube 63		
	4453 251-068 Couple bearing SolidScreen with double axle and bearings. For multiple screens in one cover with individual control.		
	4453 254-068 Alu couple bearing tube 63		
	4453 255-068 Couple bearing tube 78 SolidScreen with double axle and bearings. For multiple screens in one cover with individual control.		

= Article will be sold out. Special orders remain possible.

SolidScreen® XS

Part number	Description	Paint finish	Length in m ¹ Pack. Unit
-------------	-------------	--------------	--

The parts mentioned below use in combination with Screen 75 and 85 with alu roller 51 mm

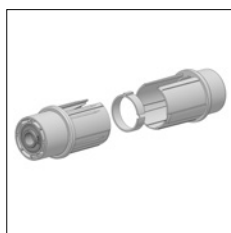

4453 464-008	Kit with nylon bearing roller bung incl. precision bearing with high inner ring for bearing side and Motor roller bung with ring for motor side (for Electro roller 52 and Somfy motor serie 40)	Grey	
--------------	--	------	--

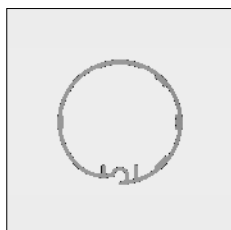

6296 454-000	Alu electro roller 51	Mill finish	7.0
6296 454-016	Idem	Silver anodised	7.0



6253 071-000	Reinforcement bar 3 mm (for electro roller 51)		3.0
--------------	--	--	-----



4453 248-068	Nylon couple bearing for roller 51. Max. 1 x coupling. ATTENTION !! The alu roller and roller bungs of the couple bearing must be rounded to protect the fabric.		
--------------	---	--	--

SolidScreen XS with headbox 75 mm

For SolidScreen XS 75, the top cover 75 slanted, slanted with lip, square and end fix brackets of Excellent 75 WITHOUT SPINDLE can be used (see chapter 6B):

Use the nylon fixing plates below in combination with the end fix bracket 75 without spindle. For bearing side and Motor side.

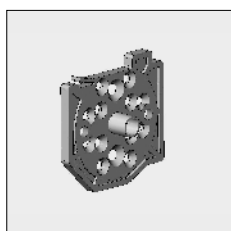

4452 670-080	Nylon fixing plate 75 with spindle 12, left	Grey	25
4452 672-080	Idem, right	Black	25

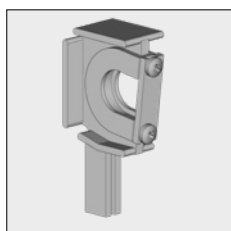

4452 545-068	Alu centre bracket SolidScreen 75		
--------------	-----------------------------------	--	--

= Article will be sold out. Special orders remain possible.

Part number	Description	Paint finish	Length in m ¹ Pack. Unit
-------------	-------------	--------------	--

SolidScreen XS with headbox 85 mm

For SolidScreen XS 85, the top cover 85 slanted, slanted with lip, square and end fix brackets of Excellent 85 WITHOUT SPINDLE can be used (see chapter 6C):

**Use the nylon fixing plates below in combination with the end fix bracket 85 without spindle.
For bearing side and Motor side.**

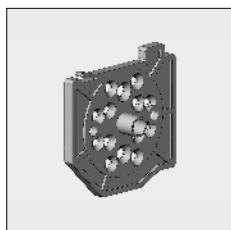

4452 680-080	Nylon fixing plate 85 with spindle 12, left	Grey	25
4452 682-080	Idem, right	Black	25

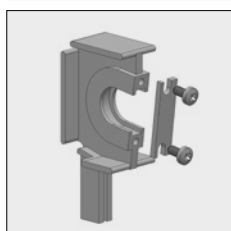

4452 547-068	Alu centre bracket SolidScreen 85		
--------------	-----------------------------------	--	--

The parts mentioned below are for headbox 75/85/95 mm.

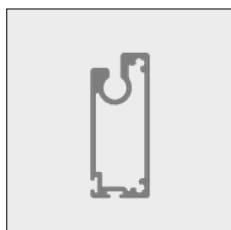

6297 734-000	Alu bottom slat square SolidScreen	Mill finish	7.0
6297 734-016	Idem	Silver anodized	7.0
6297 734-006	Idem	RAL 9010 pure white	7.0
6297 734-901	Idem	RAL 9001 cream	7.0
6297 734-716	Idem	RAL 7016 anthracite grey	7.0
6297 734-755	Idem (* = textured)	RAL 7016 anthracite grey*	7.0

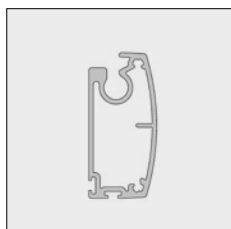

6297 744-000	Alu bottom slat rounded SolidScreen	Mill finish	7.0
6297 744-016	Idem	Silver anodized	7.0
6297 744-006	Idem	RAL 9010 pure white	7.0
6297 744-901	Idem	RAL 9001 cream	7.0
6297 744-716	Idem	RAL 7016 anthracite grey	7.0
6297 744-755	Idem (* = textured)	RAL 7016 anthracite grey*	7.0

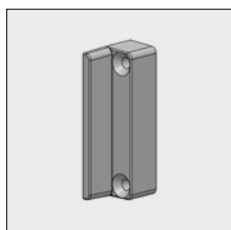

4452 470-008	Nylon end cap bottom slat square front side	Grey	10
4452 470-006	Idem	White	10
4452 470-901	Idem	Cream	10
4452 470-905	Idem	Black	10

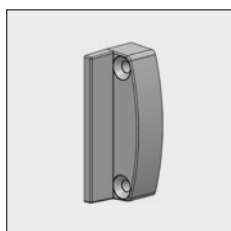

4452 472-008	Nylon end cap bottom slat rounded front side	Grey	10
4452 472-006	Idem	White	10
4452 472-901	Idem	Cream	10
4452 472-905	Idem	Black	10

= Article will be sold out. Special orders remain possible.

SolidScreen® XS

Part number	Description	Paint finish	Length in m ¹ Pack. Unit
4452 475-008	Nylon universal end cap bottom slat rear side	Grey	10
4452 475-006	Idem	White	10
4452 475-901	Idem	Cream	10
4452 475-905	Idem	Black	10

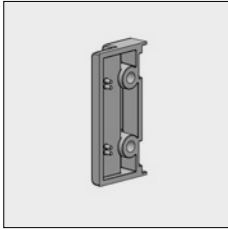

**The bottom slat heavy version below is applicable on Solidscreen XS.
Meant for an extra weight (double reinforcement) for very high/small screens (e.g. 80 x 250 cm).
E.g. 2 times the reinforcement 25 x 12 mm(6253 067-000) or 1 time 25 x 12 and 1 or 2 times 28 x 3 mm (5302 130-000).**

6297 754-000	Alu bottom slat SolidScreen square heavy	Mill finish	5.0
6297 754-016	Idem	Silver anodized	5.0
6297 754-006	Idem	RAL 9010 pure white	5.0
6297 754-901	Idem	RAL 9001 cream	5.0
6297 754-716	Idem	RAL 7016 anthracite grey	5.0
6297 754-755	Idem (* = textured)	RAL 7016 anthracite grey*	5.0

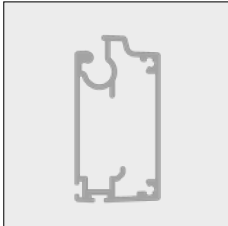

6297 755-000	Alu bottom slat SolidScreen square heavy	Mill finish	6.0
6297 755-016	Idem	Silver anodized	6.0
6297 755-006	Idem	RAL 9010 pure white	6.0
6297 755-901	Idem	RAL 9001 cream	6.0
6297 755-755	Idem (* = textured)	RAL 7016 anthracite grey*	6.0

6297 756-000	Alu bottom slat SolidScreen square heavy	Mill finish	7.5
--------------	--	-------------	-----

4452 474-008	Nylon universal end cap bottom slat square heavy front side, left	Grey	
4452 474-006	Idem	White	
4452 474-901	Idem	Cream	
4452 474-905	Idem	Black	

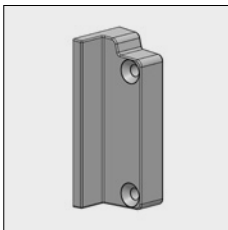

4452 476-008	Nylon end cap bottom slat square heavy front side, right	Grey	
4452 476-006	Idem	White	
4452 476-901	Idem	Cream	
4452 476-905	Idem	Black	

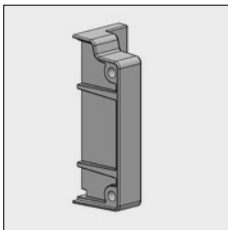

4452 477-008	Nylon universal end cap bottom slat heavy rear side	Grey	
4452 477-006	Idem	White	
4452 477-901	Idem	Cream	
4452 477-905	Idem	Black	

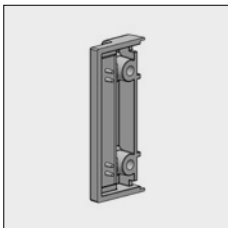

4452 077-000	Plate screw with countersunk Philips head 3.5 x 32 (For fixing the end cap bottom slat front side to the bottom slats)		100
--------------	---	--	-----



= Article will be sold out. Special orders remain possible.

Part number	Description	Paint finish	Length in m ¹ Pack. Unit
-------------	-------------	--------------	--



4452 073-000	Plate screw with countersunk Philips head 3.5 x 19 mm (For fixing the end cap bottom slat rear side to end cap bottom slat front side)		100
--------------	---	--	-----



This bottom slat Niche can also be used for the normal SolidScreens, see chapter 6M page 5. Bottom slat 6297 860- , end cap set 4453 220-905 and screws 452 555-000.

ATTENTION! : Be aware that this profile is wider than the normal SolidScreen slat. Only use this slat with the high side guides 6297 780- ... (45 x 49 mm) or the side guides should be filled out, so there will be enough space between de bottom slat and the wall.

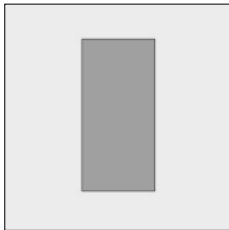

6253 067-000	Steel reinforcement strip 25 x 12 mm for bottom slat SolidScreen (After cutting the reinforcement strip, treat the cutted side with alu zinc spray part no. 5760 273-000 refer to chapter 9B)	Zinc-plated	3.05
--------------	---	-------------	------



6297 740-000	Nylon tube. To be used as as padding between 2 pieces reinforcement in the bottom slats SolidScreen.	Grey	4.0
--------------	--	------	-----



4452 238-000	Neoprene strip 10 x 2 mm self-adhesive, for suppression of impact sound between the bar and the bottom slat.		50
--------------	--	--	----

One can choose the bristle 5 mm or 8 mm to insert into the bottom slat:



4452 277-000	Bristle 5 mm for bottom slat SolidScreen	Grey	100
4452 276-000	Bristle 8 mm for bottom slat SolidScreen	Grey	100



4452 283-000	PVC (soft) inlay, bottom slat SolidScreen	Black	300
4452 283-068	Idem, length 7.0 m.	Black	7.0

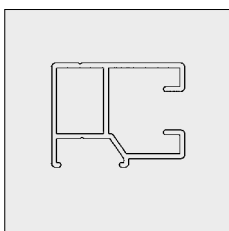

6297 830-000	Alu side guide SolidScreen XS 35 x 27.6 mm	Mill finish	7.5
6297 830-016	Idem	Silver anodized	7.5
6297 830-006	Idem	RAL 9010 pure white	7.5
6297 830-901	Idem	RAL 9001 cream	7.5
6297 830-716	Idem	RAL 7016 anthracite grey	7.5
6297 830-755	Idem (* = textured)	RAL 7016 anthracite grey*	7.5

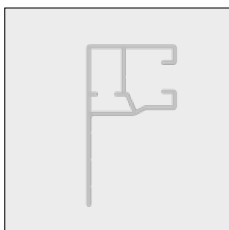



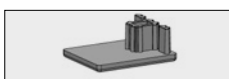

6297 824-000	Alu side guide 'LHTF' SolidScreen 35 x 63.5 mm	Mill finish	7.5
6297 824-016	Idem	Silver anodized	7.5
6297 824-006	Idem	RAL 9010 pure white	7.5
6297 824-901	Idem	RAL 9001 cream	7.5
6297 824-716	Idem	RAL 7016 anthracite grey	7.5

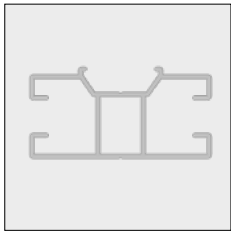

4452 479-905	Nylon end cap side guide XS	Black	10
--------------	-----------------------------	-------	----

= Article will be sold out. Special orders remain possible.

SolidScreen® XS

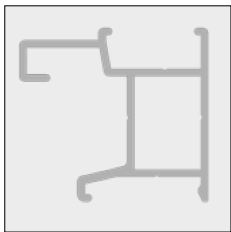
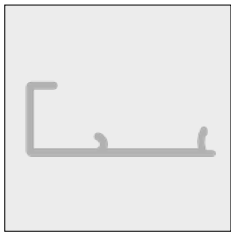
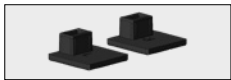
Part number	Description	Paint finish	Length in m ¹ Pack. Unit
			
6297 833-000	Alu centre guide SolidScreen XS 55 x 27.6 mm	Mill finish	7.5
6297 833-016	Idem	Silver anodized	7.5
6297 833-006	Idem	RAL 9010 pure white	7.5
6297 833-901	Idem	RAL 9001 cream	7.5
6297 833-716	Idem	RAL 7016 anthracite grey	7.5
			
4453 150-905	Nylon end cap centre guide XS	Black	10
			
4217 190-000	(AISI410) drill screw BK/KK 4.2 x 13 mm (For fixing the end cap to the side guide)		100
			
5651 170-080	Nylon end cap 10 mm	Grey	500
5651 172-080	Idem	White	500
5651 174-080	Idem	Braun	500
5651 186-080	Idem	Cream "9001"	500
5651 171-080	Idem	Ivory "1015"	500
5651 177-080	Idem	Green "6005"	500
5651 178-080	Idem	Green "6009"	500
5651 181-080	Idem	Blue "5013"	500
5651 185-080	Idem	Blue "5011"	500
5651 187-080	Idem	Anthracite grey "7016"	500
5651 180-080	Idem	Black "9011"	500
5651 175-080	Idem	Alu "9006"	500
5651 182-080	Idem	Red "3005"	500
<p>Below mentioned side guide with click profile (35 x 34 mm) can also be mounted as recess fitting and through the click profile there are no fasteningscrews visible. To gain a perfect fitting of the click cover it's only in a powder coated version applicable. Available mid-March 2017.</p>			
			
6298 580-000	Alu side guide SolidScreen XS for click profile	Mill finish	7.5
6298 580-006	Idem	RAL 9010 pure white	7.5
6298 580-901	Idem	RAL 9001 cream	7.5
6298 580-716	Idem	RAL 7016 anthracite grey	7.5
6298 580-755	Idem (* = textured)	RAL 7016 anthracite grey*	7.5
			
6298 590-000	Alu click profile SolidScreen XS	Mill finish	7.5
6298 590-006	Idem	RAL 9010 pure white	7.5
6298 590-901	Idem	RAL 9001 cream	7.5
6298 590-716	Idem	RAL 7016 anthracite grey	7.5
6298 590-755	Idem (* = textured)	RAL 7016 anthracite grey*	7.5
			
4150 751-905	Nylon end caps (kit L/R) for side guide with click profile	Black	10

= Article will be sold out. Special orders remain possible.

Part number	Description	Paint finish	Length in m ¹ Pack. Unit
-------------	-------------	--------------	--



4217 190-000	Drill screw 4,2 x 13 mm (for fastening the end cap to the guide)		100
--------------	---	--	-----

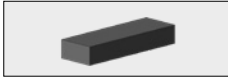

4453 154-000	Neoprene strip 8 x 10 x 30 mm self-adhesive. Install every 50 cm approx. on the side guide to mount the click profile		120
--------------	---	--	-----

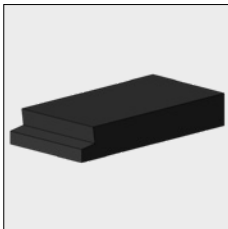
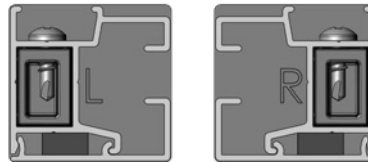

4453 155-000	Tool for (de)mounting the click profile		
--------------	---	--	--

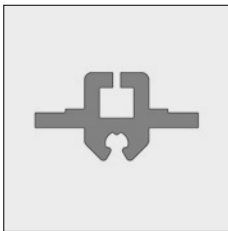

4452 481-008	Nylon guide for single guide and centre guide	Grey	6.0
4452 485-008	Idem		7.0
4452 484-008	Idem		7.5

**The side guides can be delivered incl. neoprene strips. Only in lengths of 7500 mm.
Please contact the sales department for information about the minimum quantity and delivery time.**



4452 487-000	Neoprene strip 10 x 4 x 60 mm self-adhesive. Install every 50 cm approx. on the nylon guide of the SolidScreen (4452 485-008)		135
--------------	---	--	-----

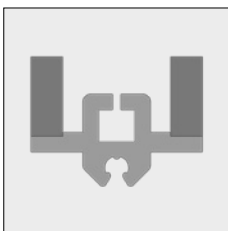

4452 453-068	Nylon guide for single guide and centre guide SolidScreen incl. neoprene strips. Packed in 20 lengths. This article is also available in bulk packaging (500 lengths) 4452 453-008.	Grey	7.5
--------------	--	------	-----



4452 486-008	Nylon funnel for side guide SolidScreen (4452 485-008)	Grey	50
--------------	--	------	----



4452 070-000	Plate screw with countersunk Philips head 2.9 x 19 mm (For fixing the funnel on nylon side guide)		100
--------------	--	--	-----

**Further requirements:
- Rollers refer to Chapter 1**

= Article will be sold out. Special orders remain possible.