

Aperta® square bar awning

3

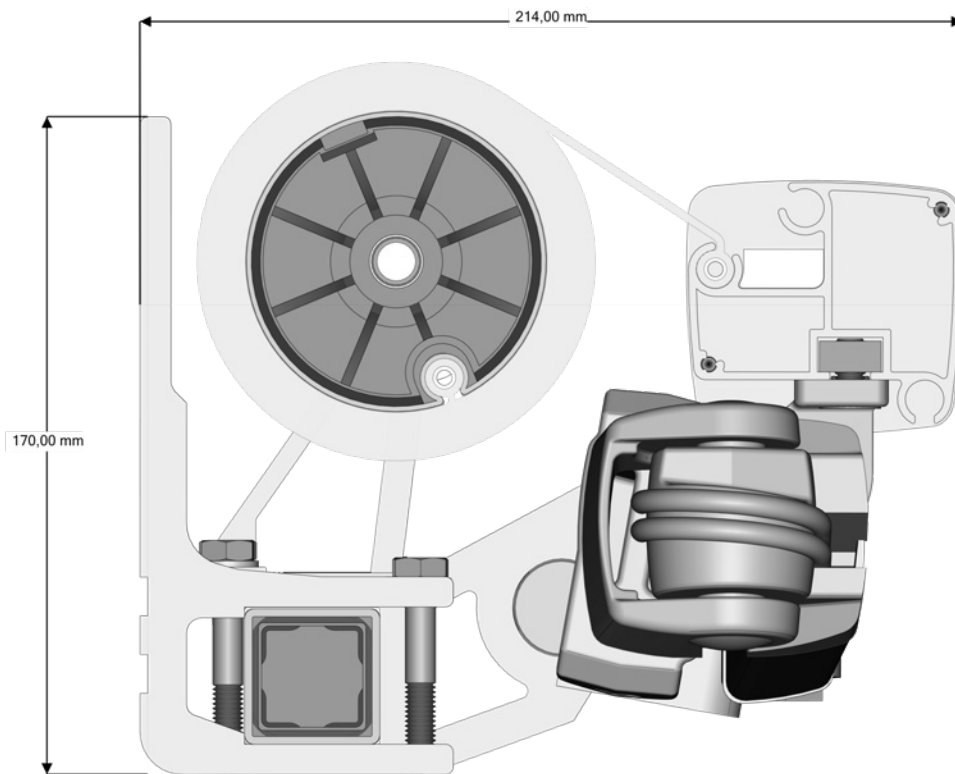
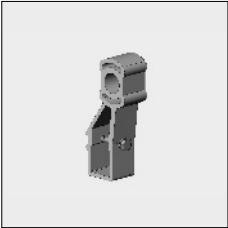
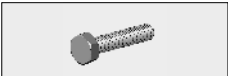

Aperta® square bar awning

Part number	Description	Paint finish	Length in m ¹ Pack. Unit
	4210 460-068	Alu wall bracket Aperta	Mill finish
	4210 460-008	Idem	RAL 7035 light grey
	4210 460-006	Idem	RAL 9010 pure white
	4212 224-008	Nylon end cover for wall brackets	RAL 7035 light grey
	4212 224-006	Idem	RAL 9010 pure white
	4210 923-090	Alu ceiling bracket for Aperta	Mill finish
	4210 923-008	Idem	RAL 7035 light grey
	4210 923-006	Idem	RAL 9010 pure white
ATTENTION !! Wall and ceiling brackets are to be positioned not further than 10 cm from the arm bracket!			
	4210 400-090	Alu end support for support roller system, width 2 cm complete with fixing material	Mill finish
	4210 400-008	Idem	RAL 7035 light grey
	4210 400-006	Idem	RAL 9010 pure white
	4210 405-090	Alu end support extra stable for support roller system, width 4 cm, incl. fixing material (to be used with motor serie 60)	Mill finish
	4210 405-008	Idem	RAL 7035 light grey
	4210 405-006	Idem	RAL 9010 pure white
	4210 478-000	Bearing pin for support roller system	
	4000 280-000	Stainless steel tap bolt M6 x 30 mm, for fixing the bearing pin to the end support 4210-400-...	50
	4210 974-000	Stainless steel tap bolt M6 x 50 mm, for fixing the bearing pin to the end support 4210-405-...	50
	4410 402-000	Stainless steel washer M 6	100

= Article will be sold out. Special orders remain possible.

Aperta® square bar awning

3

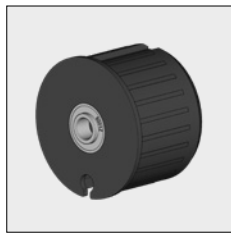

Part number	Description	Paint finish	Length in m ¹ Pack. Unit
4470 080-068	Nylon bearing roller bung 78 incl. bearing with increased inner ring	Grey	10

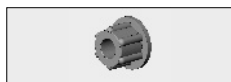

4210 520-080	Nylon packing bearing with 12 mm spindle hole, to be used at the non-operation side		50
--------------	---	--	----

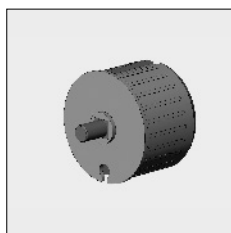

4470 092-000	Nylon bearing roller bung 78, with spindle 12 x 20 mm, flange 3 mm	Grey	10
--------------	--	------	----

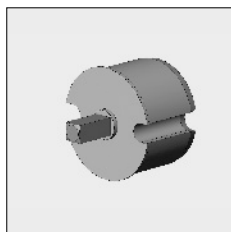

4000 330-000	Alu mono plug 78, with square spindle 13 x 30 mm, flange 3 mm		
--------------	---	--	--

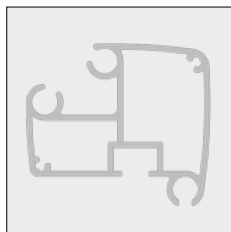

6294 303-000	Alu front profile Aperta	Mill finish	5.0
6294 305-000	Idem	Mill finish	6.0
6294 308-000	Idem	Mill finish	7.5
6294 303-016	Alu front profile Aperta	Silver anodized	5.0
6294 305-016	Idem	Silver anodized	6.0
6294 308-016	Idem	Silver anodized	7.5
6294 303-006	Alu front profile Aperta	RAL 9010 pure white	5.0
6294 305-006	Idem	RAL 9010 pure white	6.0
6294 308-006	Idem	RAL 9010 pure white	7.5

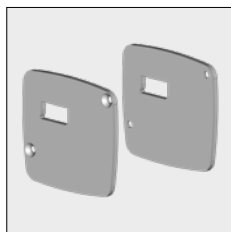

4210 470-000	Alu end cap for front profile Aperta, left	Mill finish	
4210 472-000	Idem, right	Mill finish	
4210 470-001	Alu end cap for front profile Aperta, left	Silver anodized	
4210 472-001	Idem, right	Silver anodized	
4210 470-006	Alu end cap for front profile Aperta, left	RAL 9010 pure white	
4210 472-006	Idem, right	RAL 9010 pure white	

= Article will be sold out. Special orders remain possible.

Part number	Description	Paint finish	Length in m ¹ Pack. Unit
-------------	-------------	--------------	--



4000 336-068 Stopper for square bar awning
To be mounted in front profile Aperta

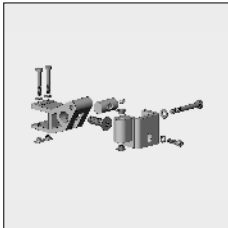

4210 330-090	Alu arm bracket, left	Mill finish	
4210 332-090	Idem, right	Mill finish	
4210 330-008	Alu arm bracket, left	RAL 7035 light grey	
4210 332-008	Idem, right	RAL 7035 light grey	
4210 330-006	Alu arm bracket, left	RAL 9010 pure white	
4210 332-006	Idem, right	RAL 9010 pure white	

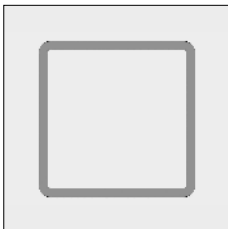

Steel square bar 35:

6253 015-000	Steel square bar 35 x 35 x 2 mm	zinc-plated	4.0
6253 016-000	Idem	zinc-plated	4.5
6253 020-000	Idem	zinc-plated	5.0
6253 021-000	Idem	zinc-plated	6.0
6253 022-000	Idem	zinc-plated	7.0
6253 024-000	Idem	zinc-plated	7.5

6253 015-008	Steel square bar 35 x 35 x 2 mm	RAL 7035 light grey	4.0
6253 020-008	Idem	RAL 7035 light grey	5.0
6253 021-008	Idem	RAL 7035 light grey	6.0
6253 022-008	Idem	RAL 7035 light grey	7.0
6253 024-008	Idem	RAL 7035 light grey	7.5

6253 015-006	Steel square bar 35 x 35 x 2 mm	RAL 9010 pure white	4.0
6253 020-006	Idem	RAL 9010 pure white	5.0
6253 021-006	Idem	RAL 9010 pure white	6.0
6253 022-006	Idem	RAL 9010 pure white	7.0
6253 024-006	Idem	RAL 9010 pure white	7.5



4210 582-000	Nylon sealing cap for square bar 35 x 35 x 2mm	Grey	50
4210 580-000	Idem	White	50
4210 581-000	Idem	Black	50

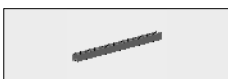

4000 324-068 Alu joint piece for steel tube 35 x 35 x 2 mm
(length 50 cm)

= Article will be sold out. Special orders remain possible.

Aperta® square bar awning

3

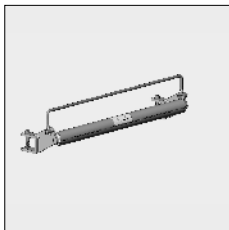

Part number	Description	Paint finish	Length in m ¹ Pack. Unit
4210 977-008	# Fabric groove sealing strip with guide bracket (length 50 cm)	RAL 7035 light grey	
4210 977-006	# Idem	RAL 9010 pure white	

Note: The guide bracket provides a nice connection between the sealing fabric and awning fabric.

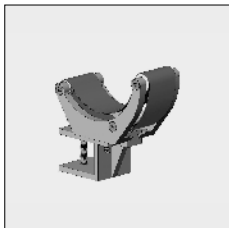

4210 978-008	Alu bracket for roller support profile, adjustable with a tailgating strap	RAL 7035 light grey	
4210 978-006	Idem	RAL 9010 pure white	



6297 066-000	Alu roller support profile	Mill finish	7.5
6297 066-016	Idem	Silver anodized	7.5
6297 066-006	Idem	RAL 9010 pure white	7.5

Note: Always use the alu roller support profile drain in combination with the nylon fabric drain.

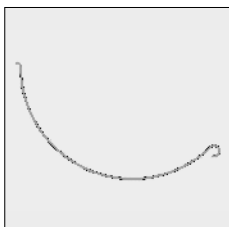

4210 315-000	Nylon fabric drain, incl. 2 adhesive-strips	Grey	5.0
--------------	---	------	-----

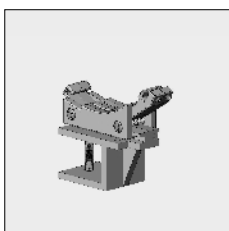

4210 982-000	Alu bracket for roller support profile	Mill finish	
4210 982-008	Idem	RAL 7035 light grey	
4210 982-006	Idem	RAL 9010 pure white	

Note: Also suitable for connecting 2 roller support profiles.

Further requirements:

- Rollers refer to Chapter 1
- Multipurpose folding arms and accessories refer to chapter 2

= Article will be sold out. Special orders remain possible.